

R-BRUSH Manual Wire Brushes

Brush accessory for cleaning out holes prior to anchor installation



Product information

Features and benefits

- Ideal for cleaning dust from drilled holes prior to applying bonded anchors or installing mechanical anchors
- Hole cleaning is necessary for correct loads
- Suitable for variable anchor embedment depths.
- Suitable for repetitive and frequent use.

Installation guide

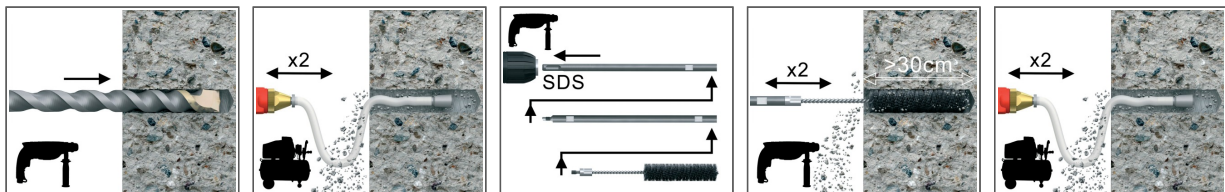

1. Drill hole to the required diameter and depth for stud size being used.
2. Before inserting anchor, clean inside of hole by compressed air starting from the drill hole bottom. Blow the hole at least twice by compressed air at minimum 6 bar.
3. Choose extensions and brushes to the selected depth and diameter of the hole, then combine them into one set.
4. Connect the drill set with the SDS tip.
5. Clean the hole twice with a prepared brush set.
6. Clean the hole again with compressed air.

Product information

Product Code	Drill diameter	Stud size	Diameter
	[mm]		D [mm]
R-BRUSH-M08/M	10	M8	12
R-BRUSH-M10/M	12	M10	14
R-BRUSH-M12/M	14	M12	16
R-BRUSH-M16/M	18	M16	20
R-BRUSH-M20/M	24	M20	26
R-BRUSH-M24/M	28	M24	30
R-BRUSH-M30/M	35	M30	37

Product commercial data

Product Code	Drill diameter [mm]	Stud size	Quantity [pcs]			Weight [kg]			Bar Codes
			Box	Outer	Pallet	Box	Outer	Pallet	
R-BRUSH-M08/M	10	M8	1	10	300	0.02	0.18	35.4	5906675249759
R-BRUSH-M10/M	12	M10	1	10	500	0.02	0.20	40.0	5906675249766
R-BRUSH-M12/M	14	M12	1	10	500	0.03	0.34	47.0	5906675249773
R-BRUSH-M16/M	18	M16	1	10	400	0.04	0.36	44.4	5906675249780
R-BRUSH-M20/M	24	M20	1	10	250	0.04	0.43	40.8	5906675249797
R-BRUSH-M24/M	28	M24	1	10	250	0.06	0.62	45.5	5906675249803
R-BRUSH-M30/M	35	M30	1	10	300	0.06	0.64	49.2	5906675249810